



**STERLING**  
**MONTESSORI**

EST. 1997

**CHILDREN'S HOUSE**  
**PK<sub>3</sub>, PK<sub>4</sub>, KINDERGARTEN**  
**Carpool Information**  
**NOVEMBER 2020**

# ARRIVAL & DISMISSAL

All Children's House students will use the carpool lane for arrival and departure. You will be issued a carpool tag during **OPEN HOUSE**. You **MUST** place your tag on the dash of your driver side during carpool

- Use the **Town Hall Drive** (see attached map)
- Arrival is between 8:25 and 9:00am.
- A **HEALTH SCREENING** and **TEMPERATURE CHECK** will take place before you child exits the car.

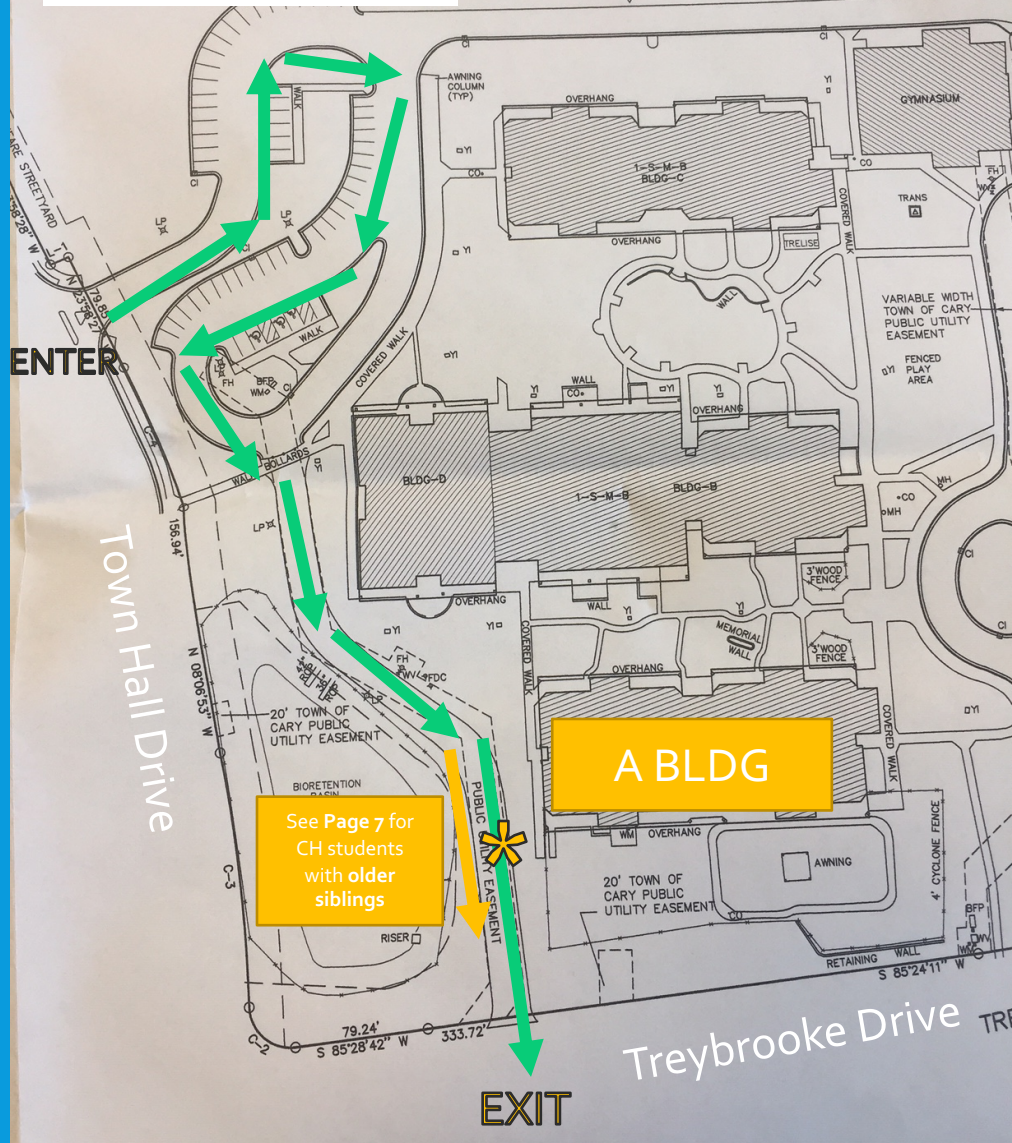

1. ENTER STERLING THROUGH TOWN HALL DRIVE
2. FOLLOW THE PARKING LOT ARROWS AROUND THE BACK PARKING LOT TO THE FIRE LANE BEHIND THE A BUILDING
  - PLEASE NOTE, THIS IS A ONE WAY ROAD
  - THIS PROCESS WILL HANDLE CARPOOL OVERFLOW AND ALLOW FOR EASE OF DROP-OFF AND PICK-UP
3. ONCE THROUGH CARPOOL, PROCEED TO EXIT ON TREYBROOK DRIVE \*\*You can only turn RIGHT when exiting back onto Treybrooke Dr.

# ARRIVAL

Arrival is between 8:25 and 9:00am

- A **HEALTH SCREENING** and **TEMPERATURE CHECK** will take place before your child exits the car.
- Please make every effort to be **ON TIME**
- Students arriving **after 9:00am** will park in the **MAIN PARKING LOT** and go directly to your classroom's patio door.
  - Park in a space; do NOT use the FIRE LANE
  - Go to your **child's classroom**, NOT the MAIN OFFICE
  - Your teacher will conduct the health and temperature checks

# TIPS FOR A SMOOTH GOODBYE IN THE MORNING



Be on Time

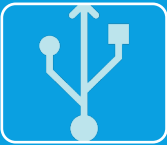

Have belongings organized and ready to bring with them. This will help separation.

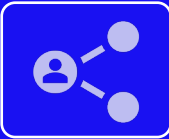

Quickly unbuckle your child



Say a quick, confident good-bye



Allow designated staff/teacher to assist your child to class

*\*\* During the the first few weeks of school, it will be important for you to understand that the carpool process can take longer than normal. Allow yourself enough time to compensate for delays.\*\**

# DISMISSAL

Carpool will start at 3:00pm - Carpool ends at 3:30pm for PK3, PK4 and Kindergarten who do NOT have an older sibling. **See next page for those with older siblings**

- Staff or teacher will escort your child to your car. Please wait until your child arrives.
- If late, your child will stay with a designated staff member until you arrive. Late fees will apply, with no exceptions

# DISMISSAL – FOR PK & K WITH OLDER SIBLINGS

We will not dismiss PK or Kindergarten students who have an older sibling in Elementary or Middle School until **3:30pm**, which is when their school day ends

- If you are a family who has a PK or K student **AND** an Elementary/Middle School and arrive before 3:30pm, you must pull into the **RIGHT LANE of the carpool area**, so we can dismiss the younger students until 3:30pm.
- We ask that if you have an older student you not arrive in the carpool lane until 3:25pm.