



**STERLING**  
**MONTESSORI**  
EST. 1997

**Carpool Information**  
**Updated April 2021**

# UPDATE FOR APRIL 2021 - JUNE 2021

In order to accommodate **MORE STUDENTS** on campus, adjustments to carpool are necessary. Changes include:

- UE & MS families **without younger siblings (YELLOW)** will drop-off/pick-up off Town Hall Drive (see page 11)
- UE/MS pick-up (**YELLOW**) should not arrive **OR PARK** until 3:20pm, to allow the CHILDREN'S HOUSE (**GREEN**) carpool line (which starts at 3:00pm) to continue to flow and not block access.
- Friday noon dismissal is only applicable for 6th-8th grade students in Blended Learning (Groups 1 and 2)

The Children's House (**GREEN**) and Lower Elementary (**BLUE**) routes and procedures remain the same.

***Please note, parents drop-off and pick-up according to the youngest student's level. If you have a student in both Children's House and the Elementary or Middle School programs, please do not arrive to pick up your students until 3:20pm. If you're only picking up a Children's House student, you must arrive by 3:30pm because the Children's House program ends at 3:30pm. \*Friday early dismissal is only applicable for 6th-8th grade students in Blended Learning (Groups 1 or 2).***

Students	Carpool Lane Color	Drop-Off	Pick-Up (Mon-Thurs)	Friday Pick-Up
Children's House Student Only	GREEN	8:25 AM	3:00 PM - 3:20 PM	
Youngest Student in the Children's House	GREEN	8:25 AM	3:00 PM - 3:30 PM	
Lower Elementary Student Only	BLUE	8:30 AM	3:30 PM - 3:45 PM	
Youngest Student in Lower Elementary	BLUE	8:30 AM	3:30 PM - 3:45 PM	
Youngest Student in Upper Elementary	YELLOW	8:30 AM	3:30 PM - 3:45 PM	12:00 PM - 12:15 PM *
Middle School Student Only	YELLOW	8:30 AM	3:30 PM - 3:45 PM	12:00 PM - 12:15 PM
Youngest Student Middle School	YELLOW	8:30 AM	3:30 PM - 3:45 PM	12:00 PM - 12:15 PM

***Any students who arrive after 9:00am are tardy. Please park your vehicle in the main parking lot and walk your child(ren) to their patio classroom door so that they may receive a temperature and questionnaire check.***

# ARRIVAL FOR ALL LEVELS

A **HEALTH SCREENING** and **TEMPERATURE CHECK** will take place before your child exits the car.

Parents must wear a mask during screening.

- Please make every effort to be **ON TIME**.
- Carpool for all PK-8th grade is from 8:30-9:00am.
- **LATE ARRIVALS:** Families arriving **after 9:00am** must park in the **MAIN PARKING LOT** and **the parent and the student** will go directly to your classroom's patio door.
  - Park in a space; do **NOT** use the **FIRE LANE**.
  - Go to your **child's classroom**, **NOT** the **MAIN OFFICE**.
  - Your teacher will conduct the health and temperature checks.

# CHILDREN'S HOUSE ARRIVAL & DISMISSAL OVERVIEW

All Children's House students will use the **GREEN CARPOOL LANE** for arrival and departure. You **MUST** place your carpool tag on the dash of your driver side during carpool.

- Use the **Town Hall Drive** to the back parking lot and fire lane.
- Arrival is between 8:25 and 9:00am; pick-up is between 3:00-3:30pm. For PK/K families with **no older siblings**, please arrive before **3:20pm**.
- A **HEALTH SCREENING** and **TEMPERATURE CHECK** will take place before your child exits the car.

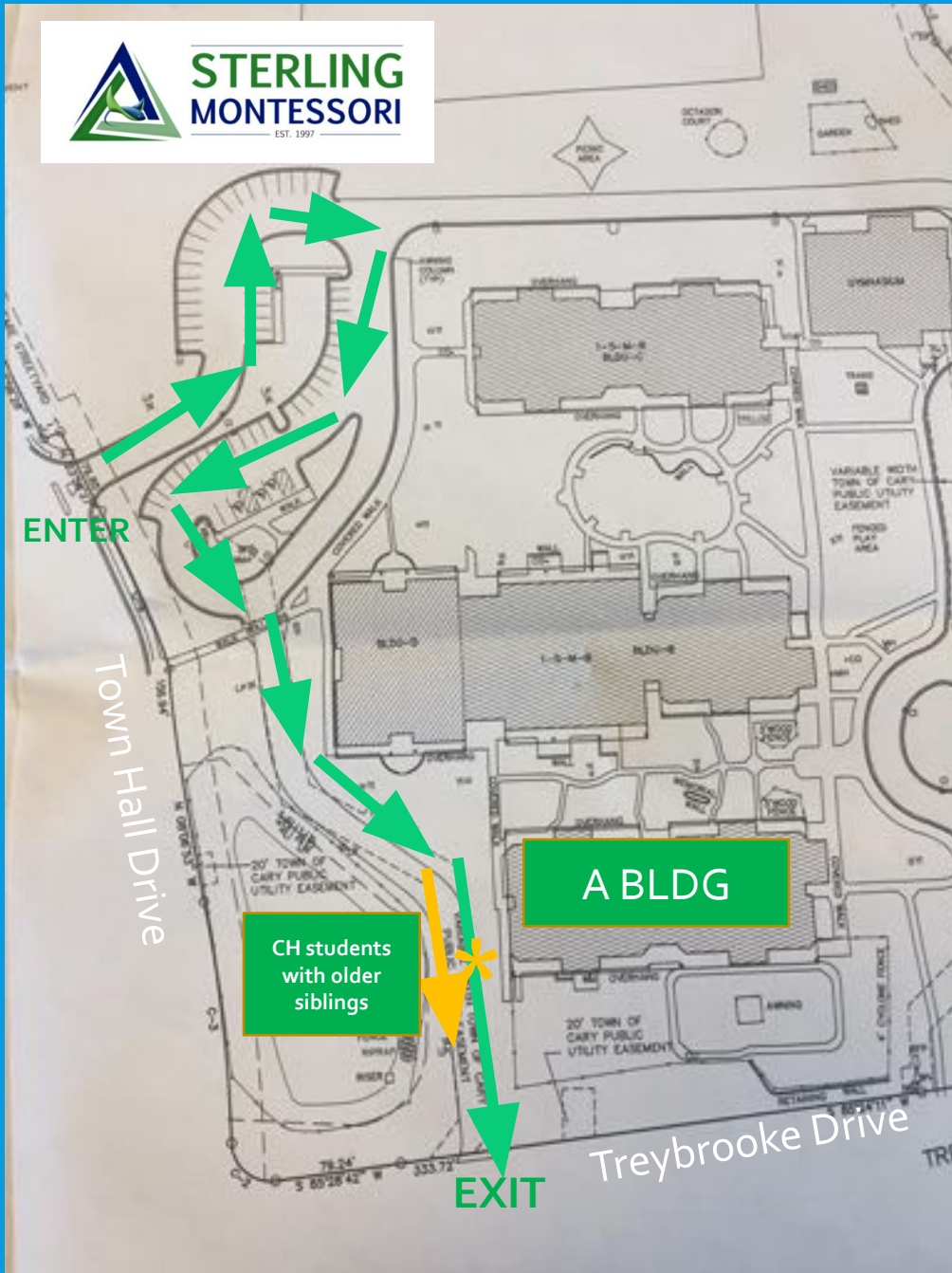

1. ENTER STERLING THROUGH TOWN HALL DRIVE
2. FOLLOW THE PARKING LOT ARROWS AROUND THE BACK PARKING LOT TO THE FIRE LANE BEHIND THE A BUILDING
  - PLEASE NOTE, THIS IS A ONE WAY ROAD
  - THIS PROCESS WILL HANDLE CARPOOL OVERFLOW AND ALLOW FOR EASE OF DROP-OFF AND PICK-UP
  - Please have students exit the vehicle on the sidewalk side.
3. ONCE THROUGH CARPOOL, PROCEED TO EXIT ON TREYBROOKE DRIVE  
**\*\*You can only turn RIGHT when exiting back onto Treybrooke Dr.**

# DISMISSAL

Carpool will start at 3:00pm - Carpool ends at 3:30pm for PK3, PK4 and Kindergarteners who do NOT have an older sibling. See next page for those with older siblings.

- Staff or teacher will escort your child to your car. Please wait until your child arrives.
- We ask that Academy and Kindergarten families with **no older siblings**, pick up by **3:20pm**.
- If late, your child will stay with a designated staff member until you arrive. Late fees will apply, with no exceptions.

# DISMISSAL – FOR PK & K WITH OLDER SIBLINGS

We will not dismiss PK or Kindergarten students who have an older sibling in Elementary or Middle School until **3:25pm**, which is when their school day ends.



# LOWER ELEMENTARY ARRIVAL & DISMISSAL OVERVIEW

All LE students will use the **BLUE CARPOOL LANE** for arrival and departure. You **MUST** hang your carpool tag on your rearview mirror during carpool.

- Use the **Treybrooke Drive** (see map) to the main parking lot to the front circle. Drop-off zones are at the front of the circle, the end of the circle and the sidewalk in front of the fence.
- Arrival is at 8:30am. Pick-up is between 3:30-3:45pm.
- A **HEALTH SCREENING** and **TEMPERATURE CHECK** will take place **before** your child exits the car. Students should get out of the vehicle to have their temperature taken. Parents must not leave until student is cleared.



## Lower Elementary Arrival & Pick-up follow the **BLUE CARPOOL LANE**

- Use the **Treybrooke Drive** to the main parking lot to the front circle.
- Drop-off zones are at the front of the circle, the end of the circle and the sidewalk in front of the fence.
- Please have students exit the vehicle on the sidewalk side.
- Arrival is at 8:30am. Pick-up is between 3:30-3:45pm.

# UPPER ELEMENTARY AND MIDDLE SCHOOL ARRIVAL & DISMISSAL OVERVIEW

All UE and MS students **without younger siblings** will use the **YELLOW CARPOOL LANE** for arrival and departure. You **MUST** hang your carpool tag on the rearview mirror during carpool.

- Use **Town Hall Drive** (see map) to the back parking to the loop between the C and D Buildings.
- Arrival is at 8:30am. Pick-up is between 3:30-3:45pm; Friday dismissal is from 12:00-12:15pm for 6th-8th grades.
- No car should be in the UE/MS line **or parked** until 3:20pm, so as to not block the Children's House carpool (**GREEN**)
- A **HEALTH SCREENING** and **TEMPERATURE CHECK** will take place before your child exits the car. Parents must not leave until student is cleared.

## Upper Elementary and Middle School Arrival and Pick-up follow the **YELLOW CARPOOL LANE**

- Use **Town Hall Drive** entrance to the back parking lot
- Pick-up on the sidewalk outside of the "C" building.
- Arrival is at 8:30am. Pick-up is between 3:30-3:45pm. Friday dismissal is between 12:00-12:15pm for 6th-8th grades.
- No car should be in the UE/MS line **or parked** until 3:20pm, so as to not block the Children's House carpool line (**GREEN**)
- Please have students exit the vehicle on the sidewalk side.

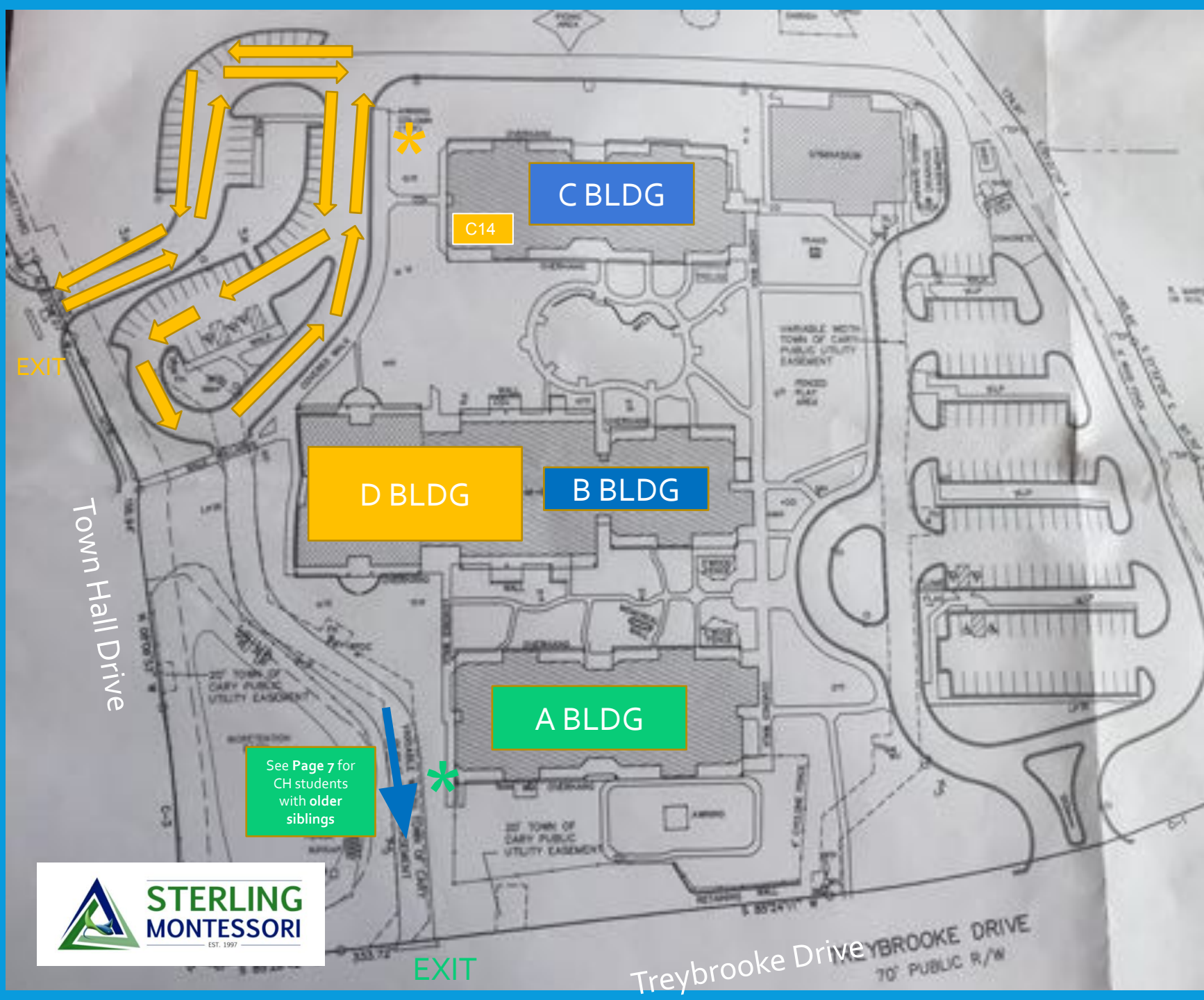

# APPENDIX: All Sterling Carpool Routes for 2021

