



STERLING
MONTESSORI
EST. 1997

Carpool Information
Updated March 2021

ARRIVAL FOR ALL LEVELS

A HEALTH SCREENING and **TEMPERATURE CHECK** will take place before you child exits the car.

- Please make every effort to be **ON TIME**.
- Carpool for all 1st-8th grade is from 8:30-9:00am. Families arriving **after 9:00am** will park in the **MAIN PARKING** LOT and **the parent and the student** will go directly to your classroom's patio door.
 - Park in a space; do NOT use the FIRE LANE.
 - Go to your **child's classroom**, NOT the MAIN OFFICE.
 - Your teacher will conduct the health and temperature checks.

Students	Carpool Lane Color	Drop-Off	Pick-Up (Mon-Thurs)	Friday Pick-Up
Children's House Student Only	GREEN	8:25 AM	3:00 PM - 3:30 PM	
Youngest Student in the Children's House	GREEN	8:25 AM	3:30 PM - 3:45 PM	
Lower Elementary Student Only	BLUE	8:30 AM	3:30 PM - 3:45 PM	
Youngest Student in Lower Elementary	BLUE	8:30 AM	3:30 PM - 3:45 PM	
Youngest Student in Upper Elementary	YELLOW	8:30 AM	3:30 PM - 3:45 PM	12:00 PM - 12:15 PM
Middle School Student Only	YELLOW	8:30 AM	3:30 PM - 3:45 PM	12:00 PM - 12:15 PM
Youngest Student Middle School	YELLOW	8:30 AM	3:30 PM - 3:45 PM	12:00 PM - 12:15 PM

Please note, parents drop-off and pick-up according to the youngest student's level. If you have a student in both Children's House and the Elementary or Middle School programs, please do not arrive to pick up your students until 3:25pm. If you're only picking up a Children's House student, you must arrive by 3:30pm because the Children's House program ends at 3:30pm.

Any students who arrive after 9:00am are tardy. Please park your vehicle in the main parking lot and walk your child(ren) to their patio classroom door so that they may receive a temperature and questionnaire check.

CHILDREN'S HOUSE ARRIVAL & DISMISSAL OVERVIEW

All Children's House students will use the **GREEN CARPOOL LANE** for arrival and departure. You **MUST** place your carpool tag on the dash of your driver side during carpool.

- Use the **Town Hall Drive** to the back parking lot and fire lane.
- Arrival is between 8:25 and 9:00am; pick-up is between 3:00-3:30pm.
- A **HEALTH SCREENING** and **TEMPERATURE CHECK** will take place before you child exits the car.

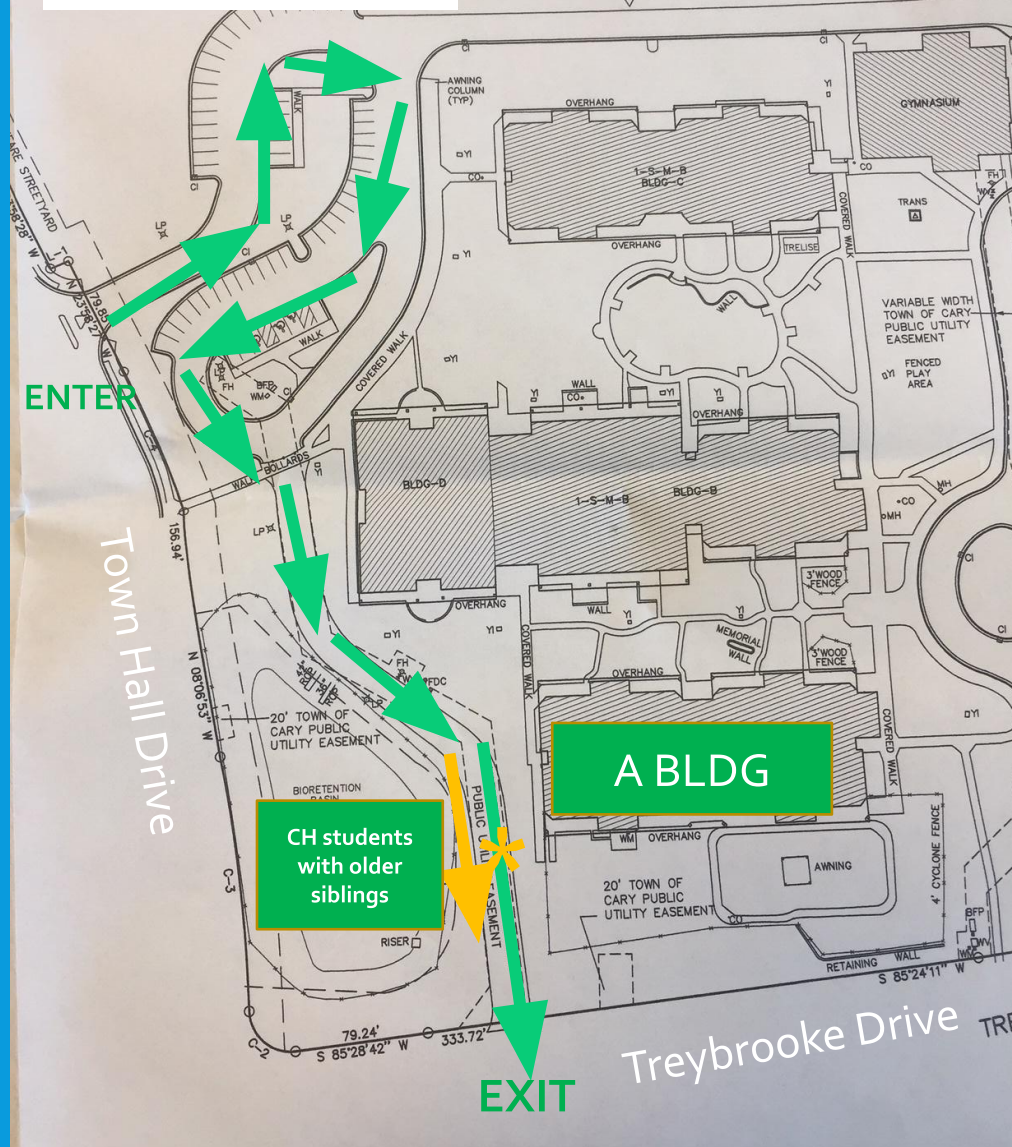

1. ENTER STERLING THROUGH TOWN HALL DRIVE
2. FOLLOW THE PARKING LOT ARROWS AROUND THE BACK PARKING LOT TO THE FIRE LANE BEHIND THE A BUILDING
 - PLEASE NOTE, THIS IS A ONE WAY ROAD
 - THIS PROCESS WILL HANDLE CARPOOL OVERFLOW AND ALLOW FOR EASE OF DROP-OFF AND PICK-UP
3. ONCE THROUGH CARPOOL, PROCEED TO EXIT ON TREYBROOK DRIVE **You can only turn RIGHT when exiting back onto Treybrooke Dr.

DISMISSAL

Carpool will start at 3:00pm - Carpool ends at 3:30pm for PK3, PK4 and Kindergarteners who do NOT have an older sibling. See next page for those with older siblings.

- Staff or teacher will escort your child to your car. Please wait until your child arrives.
- If late, your child will stay with a designated staff member until you arrive. Late fees will apply, with no exceptions.

DISMISSAL – FOR PK & K WITH OLDER SIBLINGS

We will not dismiss PK or Kindergarten students who have an older sibling in Elementary or Middle School until **3:25pm**, which is when their school day ends.

- If you are a family who has a PK or K student **AND** an Elementary/Middle School student and arrive before 3:30pm, you must pull into the **RIGHT LANE of the carpool area**, so we can dismiss the younger students with siblings beginning at 3:25pm.
- We ask that if you have an older student you do not arrive in the carpool lane until 3:25pm.

LOWER ELEMENTARY ARRIVAL & DISMISSAL OVERVIEW

All LE students will use the **BLUE CARPOOL LANE** for arrival and departure. You **MUST** hang your carpool tag on your rearview mirror during carpool.

- Use the **Treybrooke Drive** (see map) to the main parking lot to the front circle. Drop-off zones are at the front of the circle, the end of the circle and the sidewalk behind the fence.
- Arrival is at 8:30am. Pick-up is between 3:30-3:45pm.
- A **HEALTH SCREENING** and **TEMPERATURE CHECK** will take place **before** your child exits the car. Students should **remain in their vehicle** until this has occurred.

Lower Elementary Arrival & Pick-up follow the **BLUE CARPOOL LANE**

- Use the **Treybrooke Drive** to the main parking lot to the front circle.
- Drop-off zones are at the front of the circle, the end of the circle and the sidewalk behind the fence.
- Arrival is at 8:30am. Pick-up is between 3:30-3:45pm.

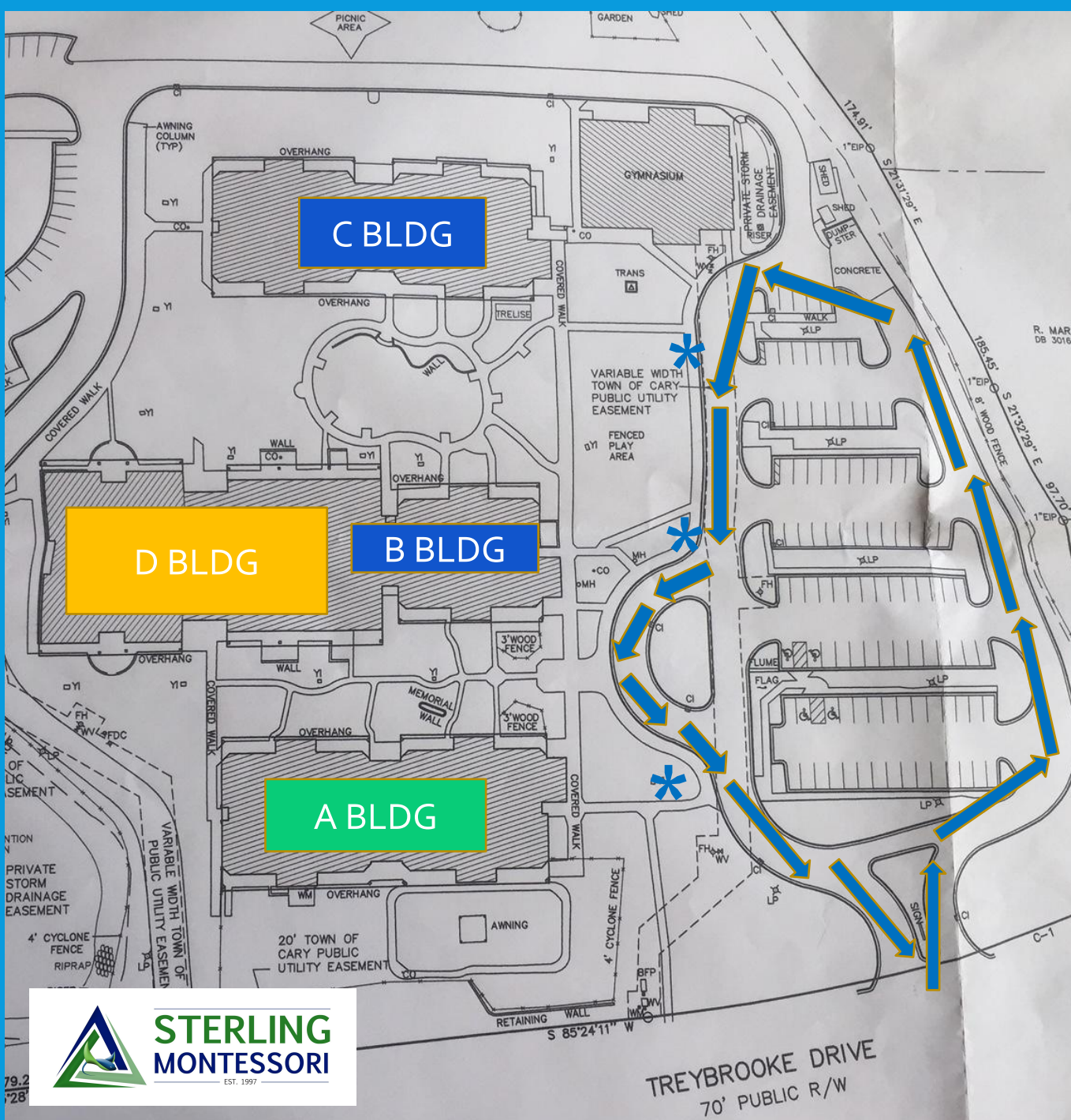

UPPER ELEMENTARY AND MIDDLE SCHOOL ARRIVAL & DISMISSAL OVERVIEW

All UE and MS students will use the **YELLOW CARPOOL LANE** for arrival and departure. You **MUST** hang your carpool tag on the rearview mirror during carpool.

- Use **Treybrooke Drive** (see map) to the main parking to the fire lane behind the Sports Court. Pick-up at the Sports Court and end of "C" building.
- Arrival is at 8:30am. Pick-up is between 3:30-3:45pm; Friday dismissal is at 12:00-12:15pm.
- A **HEALTH SCREENING** and **TEMPERATURE CHECK** will take place before you child exits the car.

Upper Elementary and Middle School Arrival and Pick-up follow the **YELLOW CARPOOL LANE**

- Use Treybrooke Drive to the main parking to the fire lane behind the Sports Court.
- Pick-up at the Sports Court and end of "C" building.
- Arrival is at 8:30am. Pick-up is between 3:30-3:45pm. Friday dismissal is between 12:00-12:15pm.
- Dismissal pick-up will be only at the initial location, near the Sports Court.



APPENDIX: All Sterling Carpool Routes for 2021

